

LEPRECHAUN

FEATURES & BENEFITS GUIDE

2021 Models

Product Produced between September 2020 thru August 2021



**WE CREATE
CUSTOMERS
FOR LIFE**

THE HISTORY OF COACHMEN RV

- Coachmen RV was founded by three brothers: Tom, Keith and Claude Corson in 1964.
- The first Coachmen RV products were manufactured in a 5,000 square foot plant in downtown Middlebury, Indiana.
- Coachmen's first year of production totaled 12 travel trailers, a single truck camper and 80 truck caps. Since then, over 750,000 Coachmen recreational vehicles have been produced.
- In December of 2008, Coachmen RV became a proud brand of Forest River, Inc., a Berkshire Hathaway company.
- Today - Coachmen RV is headquartered in Middlebury, Indiana, with our primary manufacturing facilities occupying over 220 acres with more than 23 acres under roof serving as dedicated manufacturing facilities. Our Camping Trailers are manufactured in our Centerville, Michigan, facilities occupying 90 acres.

GUIDING PRINCIPLES

"Dedicated to the enrichment of your life"

- Providing customers with long term value through all that we do. Our focus is on producing a product with superior value and backing it through superior service and support.
- Once you become a Coachmen owner, we are committed to enhancing your Coachmen RV ownership and lifestyle experience... creating friends for life and memories that will last a lifetime.

<https://coachmenrv.com/our-story>

LEPRECHAUN

The Coachmen Leprechaun offers you the “Better Stuff” discerning RVers require.



**LEPRECHAUN
“PREMIER” MODELS**

LEPRECHAUN MODELS



LEPRECHAUN

STANDARD MODELS



Leprechaun 210RS, 220XG, 230FS, 270QB, 300BH

LEPRECHAUN

STANDARD MODELS

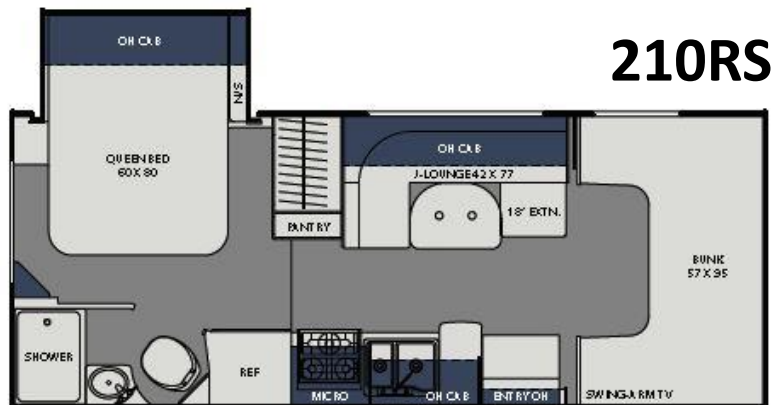

FLOOR PLAN ADVANTAGES

- RESIDENTIAL 60" X 80" WALK AROUND QUEEN BED
- 10 CU. FT., 12V REFRIGERATOR
- LARGE DOUBLE DOOR WARDROBE
- MULTI-USE 5-IN-1 J-SOFA/DINETTE
- WAREHOUSE REAR STORAGE WITH LARGE ACCESS DOOR

MODEL	21 RS
CHASSIS	E350-FORD
ENGINE	V8 – 7.3L
HORSE POWER	350
TORQUE (LBS per FT.)	468
WHEEL BASE	158"
GVWR (LBS.)	12,500
GCWR (LBS.)	18,500
UVW (APPROX. LBS.)*	9,830
CCC (APPROX. LBS.)*	2,670
GAWR FRONT (LBS.)	5,000
GAWR REAR (LBS.)	8,500
INTERIOR HEIGHT	6' 11"
EXTERIOR WIDTH	8' 4"
EXTERIOR HEIGHT (W/ A/C)	10' 11"
EXTERIOR LENGTH (W/ HITCH)	24' 3"
HITCH WEIGHT (LBS.)	5,000
FUEL CAPACITY (GAL.)	55
LP CAPACITY (LBS.)	68
FRESH WATER CAPACITY (GAL.)	50
WATER HEATER CAPACITY (GAL.)	6
GREY TANK CAPACITY (GAL.)	28
BLACK TANK CAPACITY (GAL.)	31
EXTERIOR STORAGE (CU. FT.)	67
AWNING LENGTH (FT.)	15'

LEPRECHAUN

STANDARD MODELS

220XG



FLOOR PLAN ADVANTAGES

- RESIDENTIAL 60" X 80" QUEEN MURPHY BED
- 3' X 5' REAR ENTRY DOOR
- MULTI-FUNCTION BEDROOM/CARGO BAY AREA
- 10 CU. FT., 12V REFRIGERATOR
- MULTI-USE 5-IN-1 J-SOFA/DINETTE

MODEL	22 XG
CHASSIS	E350-FORD
ENGINE	V8 – 7.3L
HORSE POWER	350
TORQUE (LBS per FT.)	468
WHEEL BASE	158"
GVWR (LBS.)	12,500
GCWR (LBS.)	18,500
UVW (APPROX. LBS.)*	9,400
CCC (APPROX. LBS.)*	3,100
GAWR FRONT (LBS.)	5,000
GAWR REAR (LBS.)	8,500
INTERIOR HEIGHT	6' 11"
EXTERIOR WIDTH	8' 4"
EXTERIOR HEIGHT (W/ A/C)	10' 11"
EXTERIOR LENGTH (W/ HITCH)	24' 3"
HITCH WEIGHT (LBS.)	5,000
FUEL CAPACITY (GAL.)	55
LP CAPACITY (LBS.)	68
FRESH WATER CAPACITY (GAL.)	41
WATER HEATER CAPACITY (GAL.)	6
GREY TANK CAPACITY (GAL.)	28
BLACK TANK CAPACITY (GAL.)	31
EXTERIOR STORAGE (CU. FT.)	38
AWNING LENGTH (FT.)	15'

LEPRECHAUN

STANDARD MODELS

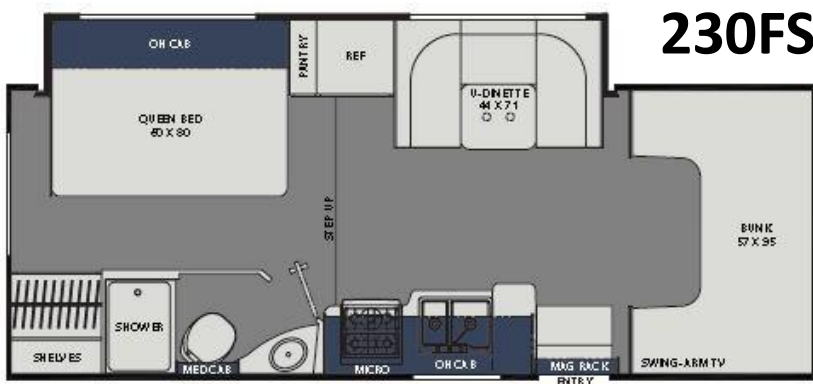

MODEL	23 FS
CHASSIS	E350-FORD
ENGINE	V8 - 7.3L
HORSE POWER	350
TORQUE (LBS per FT.)	468
WHEEL BASE	176"
GVWR (LBS.)	12,500
GCWR (LBS.)	18,500
UVW (APPROX. LBS.)*	10,800
CCC (APPROX. LBS.)*	1,700.
GAWR FRONT (LBS.)	5,000
GAWR REAR (LBS.)	8,500
INTERIOR HEIGHT	6' 11"
EXTERIOR WIDTH	8' 4"
EXTERIOR HEIGHT (W/ A/C)	10' 11"
EXTERIOR LENGTH (W/ HITCH)	26' 0"
HITCH WEIGHT (LBS.)	5,000
FUEL CAPACITY (GAL.)	55
LP CAPACITY (LBS.)	68
FRESH WATER CAPACITY (GAL.)	43
WATER HEATER CAPACITY (GAL.)	6
GREY TANK CAPACITY (GAL.)	31
BLACK TANK CAPACITY (GAL.)	31
EXTERIOR STORAGE (CU. FT.)	40
AWNING LENGTH (FT.)	17'

FLOOR PLAN ADVANTAGES

- RESIDENTIAL 60" X 80" NORTH/SOUTH FIXED QUEEN BED
- LARGE AND DEEP DOUBLE DOOR WARDROBE WITH THREE DRAWERS
- FULL WALL SLIDE INCLUDES WRAP AROUND DINETTE & BED
- WRAP AROUND DINETTE
- 10 CU. FT., 12V REFRIGERATOR

LEPRECHAUN

STANDARD MODELS

270QB

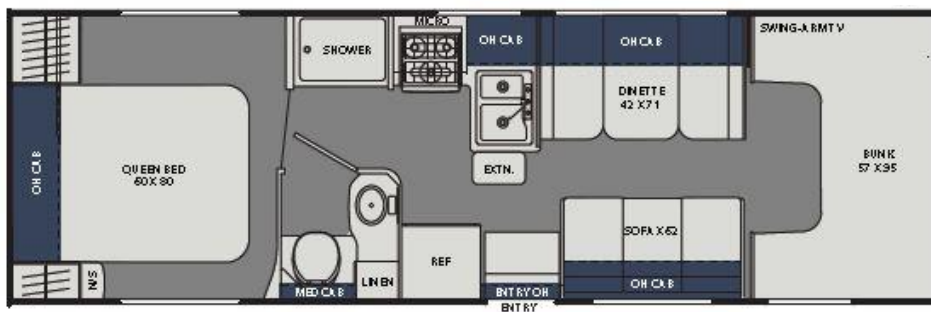

FLOOR PLAN ADVANTAGES

- RESIDENTIAL 60" X 80" WALK AROUND QUEEN BED
- 10 CU. FT., 12V REFRIGERATOR
- 90 DEGREE KITCHEN DESIGN WITH AMPLE COUNTERTOP SPACE
- OPPOSING SOFA AND DINETTE
- WAREHOUSE REAR STORAGE WITH LARGE ACCESS DOORS

MODEL	27 QB
CHASSIS	E350-FORD
ENGINE	V8 – 7.3L
HORSE POWER	350
TORQUE (LBS per FT.)	468
WHEEL BASE	190"
GVWR (LBS.)	12,500
GCWR (LBS.)	18,500
UVW (APPROX. LBS.)*	10,294
CCC (APPROX. LBS.)*	2,206
GAWR FRONT (LBS.)	5,000
GAWR REAR (LBS.)	8,500
INTERIOR HEIGHT	6' 11"
EXTERIOR WIDTH	8' 4"
EXTERIOR HEIGHT (W/ A/C)	10' 11"
EXTERIOR LENGTH (W/ HITCH)	29' 6"
HITCH WEIGHT (LBS.)	5,000
FUEL CAPACITY (GAL.)	55
LP CAPACITY (LBS.)	68
FRESH WATER CAPACITY (GAL.)	40
WATER HEATER CAPACITY (GAL.)	6
GREY TANK CAPACITY (GAL.)	31
BLACK TANK CAPACITY (GAL.)	31
EXTERIOR STORAGE (CU. FT.)	77
AWNING LENGTH (FT.)	20'

LEPRECHAUN

STANDARD MODELS



FLOOR PLAN ADVANTAGES

- RESIDENTIAL 60" X 80" WALK AROUND QUEEN BED
- ALL-IN-ONE BATHROOM
- BUNK AREA 30" X 68" DINETTE CONVERTS INTO TWO 30" X 74" BUNK BEDS
- WRAP AROUND KITCHEN DESIGN
- 10 CU. FT., 12V REFRIGERATOR

MODEL	30 BH
CHASSIS	E450-FORD
ENGINE	V8 - 7.3L
HORSE POWER	350
TORQUE (LBS per FT.)	468
WHEEL BASE	223"
GVWR (LBS.)	14,500
GCWR (LBS.)	22,000
UVW (APPROX. LBS.)*	12,470
CCC (APPROX. LBS.)*	2,030
GAWR FRONT (LBS.)	5,000
GAWR REAR (LBS.)	9,600
INTERIOR HEIGHT	6' 11"
EXTERIOR WIDTH	8' 4"
EXTERIOR HEIGHT (W/ A/C)	10' 11"
EXTERIOR LENGTH (W/ HITCH)	32' 11"
HITCH WEIGHT (LBS.)	7,500
FUEL CAPACITY (GAL.)	55
LP CAPACITY (LBS.)	68
FRESH WATER CAPACITY (GAL.)	50
WATER HEATER CAPACITY (GAL.)	6
GREY TANK CAPACITY (GAL.)	34
BLACK TANK CAPACITY (GAL.)	29
EXTERIOR STORAGE (CU. FT.)	77
AWNING LENGTH (FT.)	11'

LEPRECHAUN

“PREMIER” MODELS



Leprechaun “Premier” - 260DS, 298KB, 311FS, 319MB

LEPRECHAUN

“PREMIER” MODELS

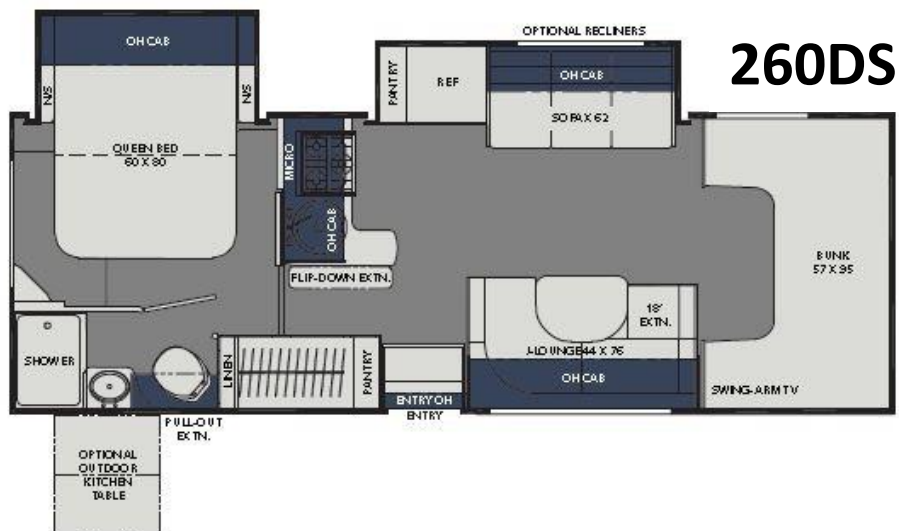

FLOOR PLAN ADVANTAGES

- RESIDENTIAL 60" X 80" WALK AROUND QUEEN BED
- 10 CU. FT., 12V REFRIGERATOR
- WRAP AROUND KITCHEN DESIGN
- MULTI-USE 5-IN-1 J-SOFA/DINETTE ACROSS FROM SOFA
- LARGE DOUBLE DOOR WARDROBE

MODEL	26 DS
CHASSIS	E450-FORD
ENGINE	V8 – 7.3L
HORSE POWER	350
TORQUE (LBS per FT.)	468
WHEEL BASE	190"
GVWR (LBS.)	14,500
GCWR (LBS.)	22,000
UVW (APPROX. LBS.)*	11,330
CCC (APPROX. LBS.)*	3,170
GAWR FRONT (LBS.)	5,000
GAWR REAR (LBS.)	9,600
INTERIOR HEIGHT	6' 11"
EXTERIOR WIDTH	8' 4"
EXTERIOR HEIGHT (W/ A/C)	10' 11"
EXTERIOR LENGTH (W/ HITCH)	27' 5"
HITCH WEIGHT (LBS.)	7,500
FUEL CAPACITY (GAL.)	55
LP CAPACITY (LBS.)	68
FRESH WATER CAPACITY (GAL.)	50
WATER HEATER CAPACITY (GAL.)	6
GREY TANK CAPACITY (GAL.)	31
BLACK TANK CAPACITY (GAL.)	31
EXTERIOR STORAGE (CU. FT.)	60
AWNING LENGTH (FT.)	18'

LEPRECHAUN

“PREMIER” MODELS

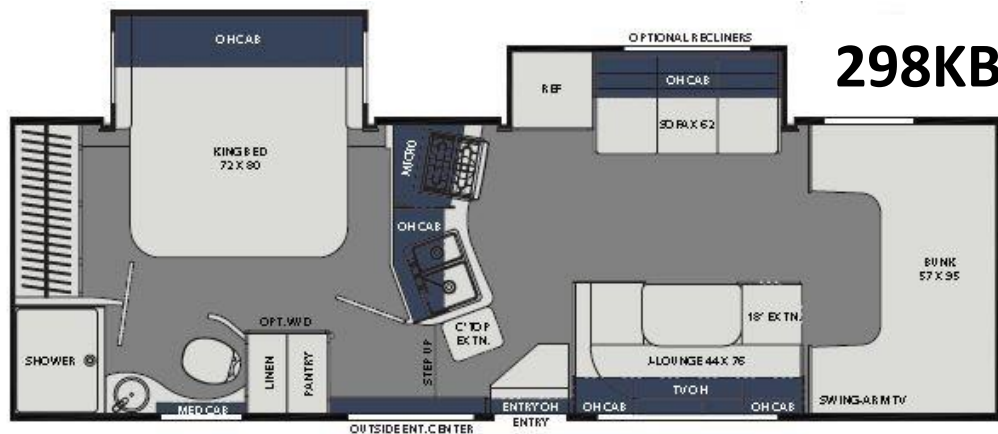

MODEL	29 KB
CHASSIS	E450-FORD
ENGINE	V8 – 7.3L
HORSE POWER	350
TORQUE (LBS per FT.)	468
WHEEL BASE	202"
GVWR (LBS.)	14,500
GCWR (LBS.)	22,000
UVW (APPROX. LBS.)*	12,300
CCC (APPROX. LBS.)*	2,200
GAWR FRONT (LBS.)	5,000
GAWR REAR (LBS.)	9,600
INTERIOR HEIGHT	6' 11"
EXTERIOR WIDTH	8' 4"
EXTERIOR HEIGHT (W/ A/C)	10' 11"
EXTERIOR LENGTH (W/ HITCH)	30' 5"
HITCH WEIGHT (LBS.)	7,500
FUEL CAPACITY (GAL.)	55
LP CAPACITY (LBS.)	68
FRESH WATER CAPACITY (GAL.)	48
WATER HEATER CAPACITY (GAL.)	6
GREY TANK CAPACITY (GAL.)	34
BLACK TANK CAPACITY (GAL.)	31
EXTERIOR STORAGE (CU. FT.)	80
AWNING LENGTH (FT.)	21'

FLOOR PLAN ADVANTAGES

- BIGGER: RESIDENTIAL 72" X 80" WALK AROUND KING BED
- BIGGER: BEDROOM WARDROBE WITH DOUBLE DOORS
- BIGGER: BATHROOM DESIGN WITH 30" X 36" SHOWER
- WASHER/DRYER PREP
- 10 CU. FT., 12V REFRIGERATOR

LEPRECHAUN

"PREMIER" MODELS



FLOOR PLAN ADVANTAGES

- RESIDENTIAL 60" X 80" WALK AROUND QUEEN BED
- BEDROOM WALK-IN CLOSET
- JACK & JILL BATHROOM WITH WASHER/DRYER PREP
- LARGE FLOOR TO CEILING PANTRY WITH FIVE PULL OUT SHELVES
- RESIDENTIAL REFRIGERATOR WITH CRISPER DRAWER AND BOTTOM FREEZER

MODEL	31 FS
CHASSIS	E450-FORD
ENGINE	V8- 7.3L
HORSE POWER	350
TORQUE (LBS per FT.)	468
WHEEL BASE	220"
GVWR (LBS.)	14,500
GCWR (LBS.)	22,000
UVW (APPROX. LBS.)*	12,350
CCC (APPROX. LBS.)*	2,150
GAWR FRONT (LBS.)	5,000
GAWR REAR (LBS.)	9,600
INTERIOR HEIGHT	6' 11"
EXTERIOR WIDTH	8' 4"
EXTERIOR HEIGHT (W/ A/C)	10' 11"
EXTERIOR LENGTH (W/ HITCH)	31' 10"
HITCH WEIGHT (LBS.)	7,500
FUEL CAPACITY (GAL.)	55
LP CAPACITY (LBS.)	68
FRESH WATER CAPACITY (GAL.)	50
WATER HEATER CAPACITY (GAL.)	6
GREY TANK CAPACITY (GAL.)	32
BLACK TANK CAPACITY (GAL.)	31
EXTERIOR STORAGE (CU. FT.)	70
AWNING LENGTH (FT.)	19'

LEPRECHAUN

“PREMIER” MODELS



FLOOR PLAN ADVANTAGES

- RESIDENTIAL 60" X 80" WALK AROUND QUEEN BED
- EXTRA LONG KITCHEN COUNTER TOP DESIGN
- 39" TV ON A MOTORIZED TELEAVATOR LOCATED IN KITCHEN COUNTER TOP
- 10 CU. FT., 12V REFRIGERATOR
- OVERSIZE 44" X 82" U-DINETTE

MODEL	31 MB
CHASSIS	E450-FORD
ENGINE	V8 – 7.3L
HORSE POWER	350
TORQUE (LBS per FT.)	468
WHEEL BASE	223"
GVWR (LBS.)	14,500
GCWR (LBS.)	22,000
UVW (APPROX. LBS.)*	11,650
CCC (APPROX. LBS.)*	2,850
GAWR FRONT (LBS.)	5,000
GAWR REAR (LBS.)	9,600
INTERIOR HEIGHT	6' 11"
EXTERIOR WIDTH	8' 4"
EXTERIOR HEIGHT (W/ A/C)	10' 11"
EXTERIOR LENGTH (W/ HITCH)	32' 11"
HITCH WEIGHT (LBS.)	7,500
FUEL CAPACITY (GAL.)	55
LP CAPACITY (LBS.)	68
FRESH WATER CAPACITY (GAL.)	50
WATER HEATER CAPACITY (GAL.)	6
GREY TANK CAPACITY (GAL.)	32
BLACK TANK CAPACITY (GAL.)	29
EXTERIOR STORAGE (CU. FT.)	100
AWNING LENGTH (FT.)	21'

2021-22 FORD E-SERIES HIGHLIGHTS



FORD E350 – (210RS, 220XG, 230FS, 270QB)

- 12,500 lb. GVWR/ 5,000 lb. Towing Hitch
- Chassis Warranty – 3 year/36,000 mile
- Drivetrain Warranty – 5 year/60,000 mile

FORD E450 – (300BH, 260DS, 298KB, 311FS, 319MB)

- 14,500 lb. GVWR/ 7,500 lb. Towing Hitch
- Chassis Warranty – 3 year/36,000 mile
- Drivetrain Warranty – 5 year/60,000 mile

NEW SAFETY FEATURES

- Electronic Stability Control
- Traction Control
- Hill Start Assist
- Auto Headlight Activation



ALL-NEW 7.3-LITER V8 GAS ENGINE

- HP: 350 @3,900 RPM
- Torque: 468 LB-FT @3,900 RPM
- 445 cubic inches
- Max torque at low RPM
- Six-speed automatic transmission

2021 FORD E-SERIES HIGHLIGHTS



OPTIONAL CHASSIS FEATURES



Available on Most Models

SWIVEL SEAT(S) – OPTIONAL

- Increases Living Room Seating
- Convenient Cockpit Table with Cup Holders
- Collapses Down for Easy Storage
- Premier Models also come equipped with Cockpit Folding Table and Exterior Windshield Cover

LEPRECHAUN

STANDARD FEATURE CONTENT



LEPRECHAUN



HARBOR MIST

LEPRECHAUN



BAYSIDE

BAYSIDE

COACHMEN CLASS C TOP FEATURES

P.O.P. POSTER



Coachmen
Leader in the Last 100 Miles

**COACHMEN CLASS C
FEATURE ADVANTAGES**

FEATURE	ADVANTAGE
<p>CRV COMFORT RIDE (on select models)</p>  <ul style="list-style-type: none"> • BILLETEN FRONT SHOCKS (Only on Chevy chassis) Proactor models only • PNEUMATIC RIDE-AWAY ADJUSTABLE REAR AIR BAGS • STABILITY CONTROL • DYNAMICALLY BALANCED DRIVE/SHIFT SYSTEM • HEAVY DUTY FRONT & REAR STABILIZER BARS 	<ul style="list-style-type: none"> • Superior handling • Flush, luxury ride • Anti-tilt safety feature • Minimizes shudder and vibrations • Adds rigidity and reduces tilting while cornering
<p>SUPERIOR CONSTRUCTION</p>   <ul style="list-style-type: none"> • CERTIFIED GREEN CONSTRUCTION • AZDEL COMPOSITE SIDEWALLS • CRIBBLER ROOF MATERIAL • QVM CERTIFIED 	<ul style="list-style-type: none"> • Modern "Cerberus" construction practices, materials, and components. • 500S aluminum legs connected exterior for a lighter weight and better finished look • "Red Backbone" and "Delamination Resistant" construction for long life and higher resale value • Roof material with a reinforced polyurethane mesh layer - synthetic thermo plastic resin generation • Coachmen RV is the only manufacturer in North America that is a ProQ QVM Certified chassis modifier
<p>CAMPING ENHANCEMENTS</p>  <ul style="list-style-type: none"> • FULL LENGTH RATIO ANTIWIG & LED RATIO LIGHT BAR • LP QUICK-CONNECT LINE • SOLAR PORT CONNECTION • WAREHOUSE STORAGE EXTERIOR COMPARTMENT 	<ul style="list-style-type: none"> • Full length patio awning with enhanced LED illumination • Accessible camp-site LP quick connect for easy grilling • Recharge the house batteries through the solar panel port • Large, utility storage area with a Rust-Resistant plastic floor that is form-fitted, will not rust, and is easy to clean
<p>COMFORT</p>  <ul style="list-style-type: none"> • RESIDENTIAL BED SIZES • LARGE CAB-OVER-AREA • OVERSIZED DINETTES 	<ul style="list-style-type: none"> • True 60" x 80" Queen Beds and 72" x 80" King Beds • 27" x 20" cab-over-bunk providing room and comfort • Lounge & lounge dinettes offer roomier seating and larger converted bed areas
<p>IMPROVED MECHANICAL SYSTEMS</p>  <ul style="list-style-type: none"> • LARGE FRESH WATER TANK • EVER-COOL DUCTING SYSTEM (on most models) • 3RD ROOFTOP A/C PSE-VOICE (on select models) 	<ul style="list-style-type: none"> • Maximum Fresh Water Capacity for extended dry camping capability and supporting more occupants • Superior cooling capability with insulated and sealed ducting which is mold and condensation resistant. • Increased Cooling Capacity with an optional 2nd A/C unit (5.3 ton profile in bedroom)

Even Cool
By Coachmen

© Copyright 2010 Coachmen RV. A Division of Forest River, Inc. All Rights Reserved.



CRV COMFORT RIDE



SUPERIOR CONSTRUCTION



CAMPING ENHANCEMENTS



COMFORT



IMPROVED MECHANICAL SYSTEMS

AIR ASSIST SUSPENSION

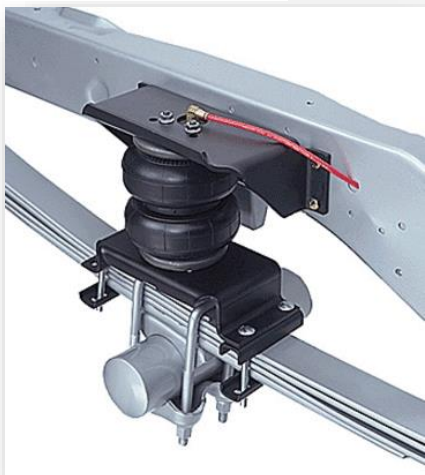

- Improved Steering Control
- Individual Inflation Valves Allow for Side-to-Side Adjustment
- Reduces Suspension Fatigue
- Reduces Bottoming Out
- Increases Vehicle Stability
- Levels Vehicle Payload for Transport
- DO NOT EXCEED 100 PSI IN AIR BAG
- Available on Select Models (See www.coachmenrv.com for Details)
- 24 month/ 24,000 mile warranty

**Equipped on 230FS, 300BH and all "Premier Package" Models*

HEAVY DUTY FRONT & REAR STABILIZER BAR



- Reduced body roll
- Improved handling and control
- Overall a more comfortable controlled ride

STABILITY CONTROL



- Stability control uses components and sensors from some of the vehicle's other safety features, including anti-lock brakes (ABS).
- Brakes stop the wheels from turning, but it's the tires gripping the asphalt that actually brings the vehicle to a halt, and even good tires can only do so much

DYNAMICALLY BALANCED DRIVESHAFT SYSTEM



- Driveline Modifications Follow Procedures & Guidelines Set by Dana Spicer, Ford, Chevy, and Other Chassis Manufacturers
- All Drivelines are balanced together as a completed system

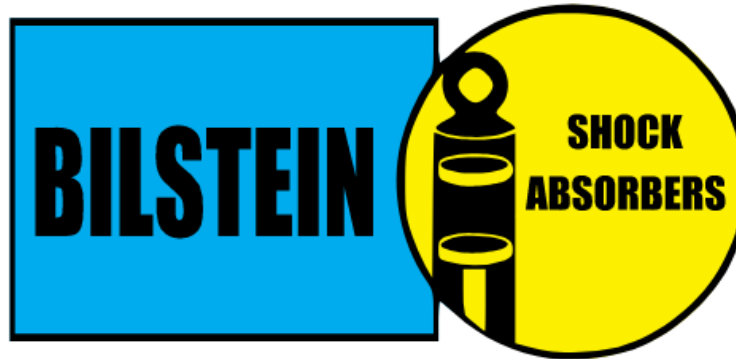

BILSTEIN SHOCK ABSORBERS

- Significant improvement in ride quality, handling, and comfort.
- Mono-tube design which provides consistent fade free performance.
- Utilize a unique, velocity sensitive, digressive piston which reacts to changing road conditions to provide consistent fade free performance.
- Tuned for each specific application to assure optimal performance is achieved.



*Equipped on all "Premier" Models (N/A Chevy Chassis)

**LOOK
FOR THIS
LABEL!**



[PDF - FULL REPORT](#)



Resource Efficiency

Factors include: the use of sustainable materials, waste reduction, recycling and reuse of materials. Wasted or inefficient use of resources equals lost profits. Lean manufacturing and environmental management systems can produce customer satisfaction and improve the bottom line.



Indoor Environmental Quality

Being green also means strong attention to indoor air quality. Important factors include: ventilation, volatile organic compounds (VOC) content in carpet, hard flooring, adhesives, sealants, cabinets and insulation.



Operation and Maintenance

Green certification by TRA acknowledges that a green assembly is only truly green if the owners use the green features to their maximum effect. Manufacturers are encouraged to not only use green processes and materials but also to educate owners on their proper use of the structure.



Energy Efficiency

A positive energy strategy includes monitoring, design, construction and appliances. Renewable and clean sources of energy generated on or off-site, are important factors in the green process.



Water Efficiency

The major goal is the smart use of water. Water reduction is typically achieved through more efficient appliances and fixtures.



Innovative Practices

Manufacturers can achieve significantly higher TRA Certification ratings through new and innovative practices that increase green capability and performance.



“ROT-RESISTANT” ALUMINUM FRAMED CONSTRUCTION

2" THICK, DUAL LAMINATED (PINCH ROLL AND VACU-BOND) SIDEWALL CONSTRUCTION

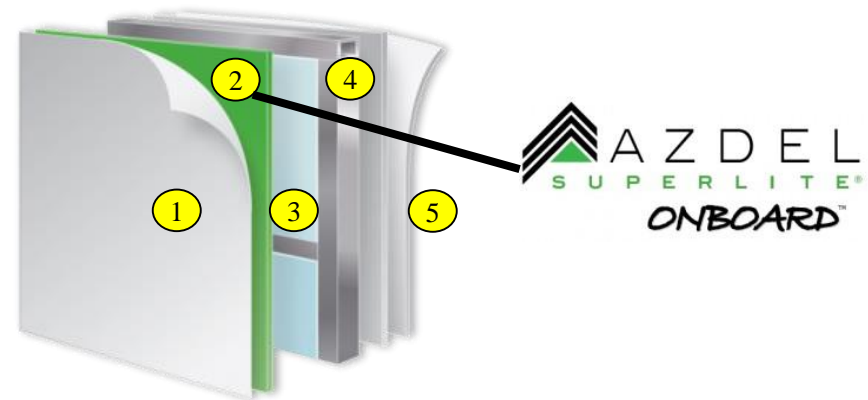
1. High gloss fiberglass exterior skin
2. Azdel composite substrate
3. Hi-density foam insulation
4. Welded aluminum framing
5. Interior décor wallboard



Lamination Video: <https://youtu.be/FxKXIbf6Ncw>

Azdel Composite Panels - Key Features			
 <p>Weight Matters™ 50% Lighter Than Wood for Lighter RVs</p>	 <p>Let It Rain™ Impervious to Water: No Rot, Mold or Water Damage</p>	 <p>from Sweats to Chills™ 3X the Insulation Value of Wood</p>	
 <p>TOXIC CHEMICAL CO₂O Odorless, Formaldehyde Free</p>	 <p>Sound & Energy Absorbing for Quieter RVs</p>	 <p>Impact & Puncture Resistant: Stronger Sidewalls Help Prevent Damage</p>	

“ROT-RESISTANT” ALUMINUM FRAMED CONSTRUCTION

VACU-BOND LAMINATED ROOF CONSTRUCTION

1. Interior ceiling board
2. Hi-density foam insulation
3. Aluminum rafters
4. Roof decking – *Full walk-on roof*
5. CrossFlex roof material

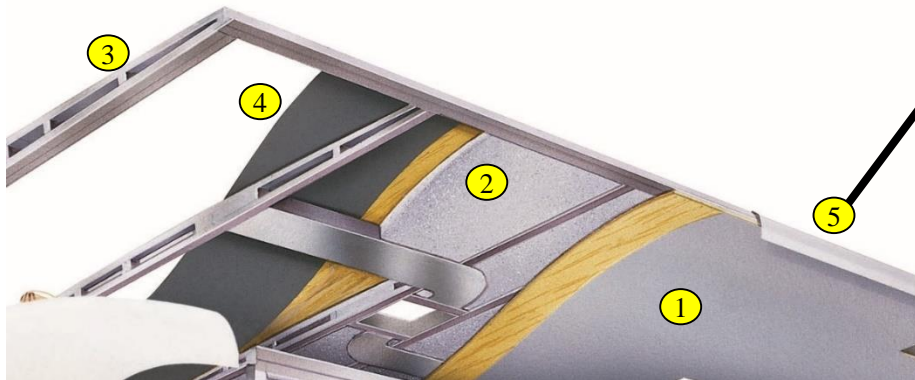

CrossFlex



- 12 Year limited material warranty
- Industries 1st synthetic thermoplastic, nylon cross-webbing roof material
- ASTM D751 Tested, 8X stronger competitive products
- Top rated puncture and tear resistance
- Lightweight and flexible
- Exceptional sealant bonding performance
- UV Resistance, high solar reflectance
- Chemical resistant
- Minimal maintenance

CrossFlex Testing Video:

<https://seamancorp.wistia.com/medias/x78bo8g24f>

“ROT-RESISTANT” ALUMINUM FRAMED CONSTRUCTION

VACU-BOND LAMINATED 2” FLOOR CONSTRUCTION

1. Galvanized steel underbelly – Durable, corrosion resistant
2. Aluminum framing – Strong, light weight
3. Hi-density foam insulation for MAX insulation R factor
4. Double layer floor decking which allows flex (1/2” total thickness)
5. Congoleum vinyl flooring

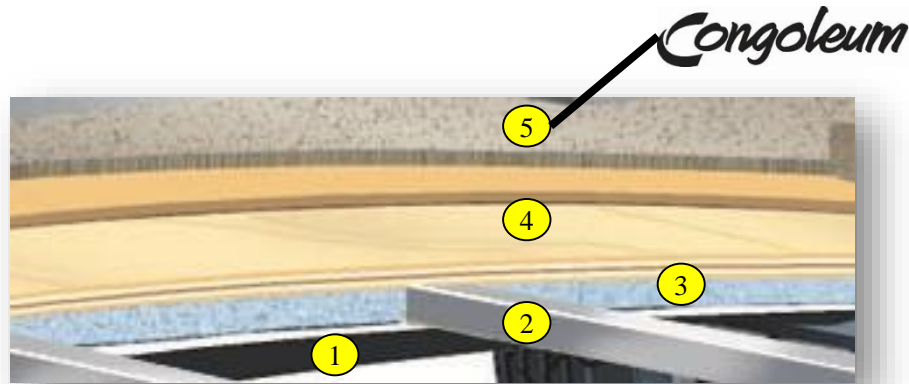

IN HOUSE CHASSIS MODIFICATIONS



- QVM (Qualified, Vehicle Modifier) Certified
- Strick Quality Control
- OEM-matching harnesses, fittings and plugs are used whenever possible
- Driveline Modifications Follow Procedures & Guidelines Set by Dana Spicer, Ford & Other Chassis Manufacturers
- Added Frame Rail Sections are done with OEM grade Steel

Chassis Prep Video:

https://youtu.be/Ntt2F_P2TPI

CAMPING ENHANCEMENTS



MAXIMUM LENGTH AWNINGS

- 12V Electric Powered
- Tilt Adjustment
- Wind Dampening Arms
- LED Patio Light Strip



WAREHOUSE STORAGE

- 60 – 100 cu. ft. of Space on Average
- Roto-Cast Polymer Floor
- Seamless Floor Bins with Drains
- Multiple Large Access Doors



LP QUICK CONNECT

- Accessible, camp-side LP quick connect for easy grilling

FURRION

Solar Power Port

(Standard)



Solar Panel
Sold Separate

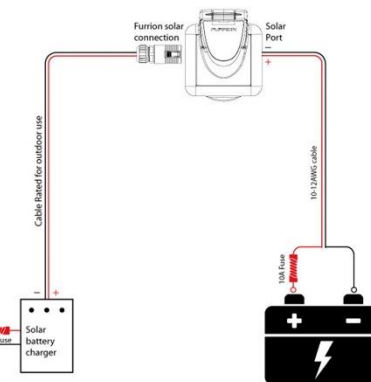



OVERSIZE DINETTES

- Large U-shape & J-lounge Dinettes
- Roomier Seating
- Larger Converted Bed Areas



LARGE CAB-OVER BUNK

- Industry Leading, 57" x 95" cab-over bunk
- Durable Aluminum Framed Bunk Area
- Bunk Ladder



RESIDENTIAL BEDS

- More Comfort
- 60" x 80" Queen Bed
- 72" x 80" King Bed (298KB)
- Deluxe Upgraded Mattress

IMPROVED MECHANICAL SYSTEMS

Fresh Water System



LARGER FRESH WATER CAPCITIES

- 20% More Fresh Water Capacity on Average Than Competitors
- Longer Dry-Camping Capability
- Ability to Service More Occupants
- Longer Time Spans Between Fill-ups
- Seamless Roto-Cast Polymer Tank



EVEN-COOL A/C DUCTING SYSTEM

(N/A 210RS, 220XG, 230FS)

- Moisture Resistant Foil Lining
- Mold Resistant Material
- Fewer Coil Freeze-ups
- Superior Airflow thru Radius Corners
- 13.5 BTU A/C (standard), 15.0 BTU A/C (optional)

DUAL A/C PRE-WIRE

(300BH and All "Premier Package" Units)

- Pre-wire Run in Ceiling, Standard
- Increased Cooling Capacity with an Optional 2nd A/C Unit
- Dual A/C Option: Ducted, 11.5 BTU A/C in Living Room, 11.5 BTU Non-Ducted A/C in the Bedroom

FURRION



High-definition on an ultra slim LED television, with enhanced audio features and a full spectrum of connectivity options:

- Steel mounting plate
- High brightness LED technology
- Vibrationsmart™ - designed for vibration resistance
- Climatesmart™ - tested for extreme climates



WINEGARD AIR 360+ TV ANTENNA

- 360° Reception – No aiming or pointing! Receiving TV signals from up to 55 miles away.
- Winegard Gateway Router Add-On – Enable preinstalled 4G LTE & Wi-Fi antennas with the Gateway. It works with Verizon, AT&T, or Winegard Data Plans.





Capacity - DC compressor technology allows Norcold to provide 10-cu. ft. of storage in the same cutout as an 8-cu. ft. RV refrigerator

Residential Styling

- Curved, reversible stainless doors
- Glass shelves and clear bins

Ready for the Road

- Integrated door and travel latches with easy-open handles
- RV refrigerator-type condensation handling
- RV-standard mounting method for easy installation without add-on brackets
- Top control panel includes venting for improved refrigerator performance



Energy Efficient - "Night Mode" reduces compressor and fan speed to conserve battery charge and reduce noise



POLAR 10DC

(N/A 311FS)

- Adjustable full/half shelf for storage flexibility
- Adjustable thermostat for adapting to changing conditions
- Separate temperature adjustments for fresh food and freezer sections
- Manual defrost extends battery charge
- Shelf retention to meet agency codes

UPGRADED WATER SYSTEM

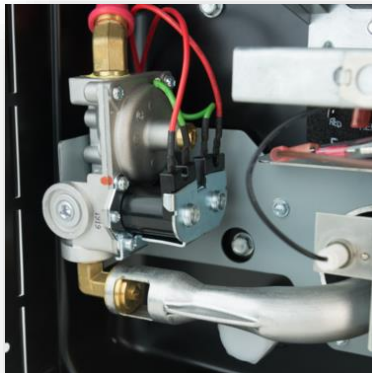
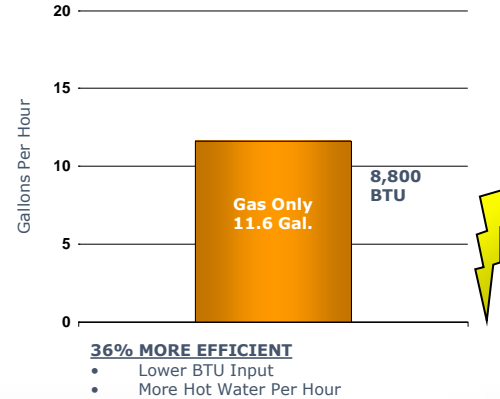

QUICK HEATING

- Burner system heats water quickly and reduces wait time
- 10,000 BTU input
- Electronic ignition gas burner system

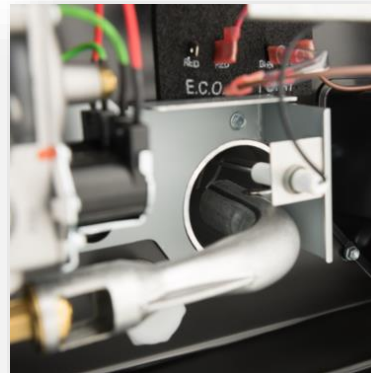

COMFORTABLE

- Water heater design allows you to enjoy hot water for longer
- Easy access low profile door

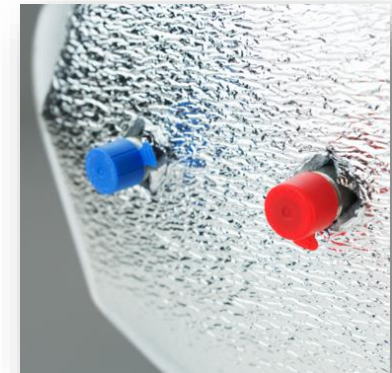

LOW MAINTENANCE

- Anode rod not required – less maintenance
- Aluminum tank is lightweight and corrosion resistant

UPGRADED WATER SYSTEM

Hep_vO



HEPvO VALVE DRAIN LINES

- No Water Used
- Low Maintenance
- No Gases or Odor From Holding Tanks
- More sanitary than P-Traps



PEX PLUMBING LINES

- Non-Toxic, superior water quality
- Requires fewer fittings reducing potential leaks
- Resists scale build-up
- Resistant to freeze-breakage
- No transfer of heat which conserves energy
- Water flows more quietly
- No "water hammer" noise

RV generator set
Quiet Gasoline™ Series
RV QG 4000



Cummins Onan

Performance you rely on.™



Testing for RV application

- Tested at extremes of temperature -20° F (-29° C) to 120° F (49° C) for starting and operation
- Tested with RV loads, air conditioners, microwaves, converter, TVs, VCRs
- Tested installed; Cummins owned RVs used for product development testing
- Tested in high humidity conditions
- Tested in salt spray conditions
- Tested in heavy airborne dust conditions
- Field test program
- 60 Hz (120 V only) models listed by SGS United States Testing Company, Inc. per ANSI/RVIA EGS-1 and CSA-certified per Electrical Bulletin 946
- This generator set was designed and manufactured in facilities certified to ISO 9001
- 60 Hz models meet applicable U.S. EPA and California emissions standards

Features and benefits

- Microprocessor control with diagnostics.
- Exceptionally smooth, quiet operation.
- Sealed connectors.
- Full housing with enclosed muffler.
- 3-year limited warranty.
- Lightweight, compact.
- OHV engine for efficiency, no decarboning.

Weight, size and sound level

- Weight** 172 lbs (83.4 kg)
- Length** 30.0 in (762 mm)
- Width** 19.7 in (500.4 mm)
- Height** 14.4 in (353.1 mm)
- Sound** 68 dB(A) Readings at 10 ft (3 m) half load
- Meets National Park Service sound level requirements (60 dB(A) @ 50 ft) for use in national parks.
 - Typical installation will further reduce sound level.

Average fuel consumption:

Gasoline
60 Hz 4.0 KY

No load
0.3 Gal/h (1.1 L/h)

Half load
0.5 Gal/h (1.8 L/h)

Full load
0.7 Gal/h (2.7 L/h)



LEPRECHAUN

STANDARD MODELS – ADDITIONAL FEATURES



EXTERIOR UPGRADES

FREELANDER

LEPRECHAUN

STANDARD MODELS



MOLDED FRONT WRAP

- Front Mounted and Fastened
- Durable Material
- Improved Structural Integrity

OPTIONAL EXTERIOR DÉCOR PACKAGES

LEPRECHAUN

STANDARD MODELS – PAINTED CHASSIS CAB





SIDEVIEW CAMERA

- Reduces Blind Spots
- Turn Signal Activated

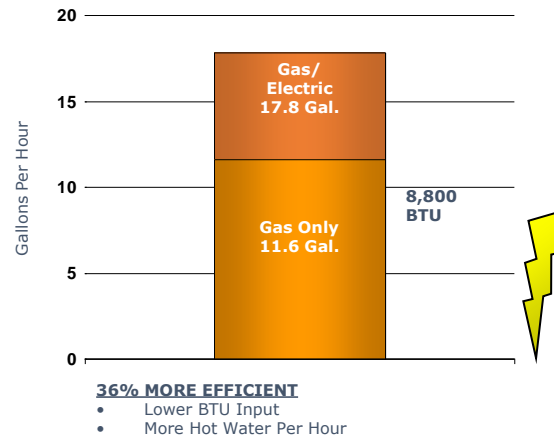

6 GAL. GAS/ELECTRIC WATER HEATER

- Burner system heats water quickly and reduces wait time
- Water heater design allows you to enjoy hot water for longer
- Aluminum tank requires no anode rod
- Electric heating element provides additional input



CONVECTION MICROWAVE

- Speed Cook with Microwave & Convection Combined
- Multi-Stage Cooking
- 4 Cooking Modes: Microwave, Convection, Grill, and Roast

LEPRECHAUN

“PREMIER” MODELS – ADDITIONAL FEATURES



LEPRECHAUN

“PREMIER” MODELS



MOLDED FRONT WRAP

- Front Mounted and Fastened
- Durable Material
- Improved Structural Integrity



MOLDED FIBERGLASS CAP WITH WINDOW - OPTIONAL

(Standard with Full and Partial Paint Options)

- Automotive Windshield Glass, Cabover Window
- Sidewall Mounted and Fastened
- Exterior LED Accent Lighting
- Molded Fiberglass Interior Cap with Directional Reading Lights

OPTIONAL EXTERIOR DÉCOR PACKAGES

LEPRECHAUN

“PREMIER” MODELS – PAINTED CHASSIS CAB



OPTIONAL EXTERIOR DÉCOR PACKAGES

LEPRECHAUN

“PREMIER” MODELS – PARTIAL BODY PAINT



OPTIONAL EXTERIOR DÉCOR PACKAGES

LEPRECHAUN

“PREMIER” MODELS – “STEEL” FULL BODY PAINT



OPTIONAL EXTERIOR DÉCOR PACKAGES

LEPRECHAUN

“PREMIER” MODELS – “STARFIRE” FULL BODY PAINT



KEY “PREMIER PACKAGE” FEATURES



“WATER WORKS” COMPARTMENT

- Black Tank Flush
- Easy Winterization
- Exterior Water Pump Switch
- Single Hose Inlet



OUTSIDE SHOWER

- Hot and Cold Water
- Flex Hose
- Show Head Holder
- Lockable Compartment



EXTERIOR TV PREP COMPARTMENT

- Standard Exterior TV Prep with 110v Outlet and Coaxial Hook-up
- Optional TV with Bluetooth/AM/FM Sound Bar Speaker, and HDMI Port

KEY “PREMIER PACKAGE” FEATURES



WIDE RUNNING BOARDS

- Sure Footing When Entering and Exiting the Cab
- Deflects Dirt, Mud and Road Debris



POWER VENTS WITH MAXXAIR COVERS

- Efficient Cooling Method in Mild Temperatures
- Increases Natural Ventilation
- MaxxAir Covers allow vents/Fans to operable in the Rain and While in Transit



DAY & NIGHT ROLLER SHADES

- Blackout Night Shade
- Daytime Solar Shade
- Superior Heat and Glair Reduction

OPTIONAL “PREMIER PLUS” FEATURES



SIDEVIEW CAMERA

- Reduces Blind Spots
- Turn Signal Activated



HEATED REMOTE MIRRORS

- Adjust Mirrors from the Cockpit
- Heat to Remove Fog or Frost
- Durable Break-away Arms

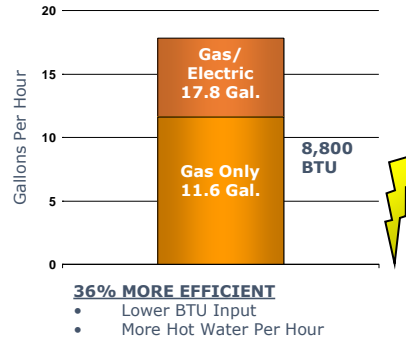

6 GAL. GAS/ELECTRIC WATER HEATER

- Heats Water Quickly and Reduces Wait Time
- Design Allows More Hot Water for Longer
- Aluminum Tank Requires No Anode Rod



HEATED TANK PADS

- Extends Camping Capability
- 12 Volt Powered
- Installed on Black and Gray Tanks



CONVECTION MICROWAVE

- Speed Cook - Microwave/Convection Combo
- Multi-Stage Cooking
- 4 Cooking Modes: Microwave, Convection, Grill, and Roast

KEY OPTIONAL “PREMIER” FEATURES



(OPTIONAL - DASH RADIO with BACK-UP CAMERA)

Concept XL-10 Chameleon 10.1” Mech-Less Stereo In-Dash with CarPlay and Android Auto



android auto Apple CarPlay

- 10-inch WVGA hovering capacitive touch screen
- Tapered display housing and silver trim for a clean, modernized fit and finish
- Standard 1-DIN chassis designed to fit aftermarket ISO Din dash kits for various vehicle applications
- Audio, video, and Bluetooth® feature set
- HD Radio tuner built in
- CPU Frequency: Octa Core Intel IA Processor, up to 1.872GH
- RAM: 2G DDR4
- Internal Storage: 32GB
- Supports 4-64GB SD cards
- Supports 4-64GB USB
- Bluetooth: Specification v2.1 + EDR, v4.2 Low Energy, Phone book download (External Bluetooth optional: Realtek8761)
- Video Display: 1080P @ 60FPS (H.264 H.265), Maximum support 4K resolution
- USB Interface: 1 USB 2.0 motherboard expandable
- SD Interface: 1 SD 3.0

KEY OPTIONAL “PREMIER” FEATURES



STANDARD



+

OPTIONAL



OPTIONAL – WINEGARD GATEWAY

- Upgrade your AIR 360+ with the Winegard Gateway for an all-in-one solution to your Internet needs
- Powerful 4G LTE & Wi-Fi for Your RV – High-performance antennas provide reliable Internet access while parked and while traveling down the road
- Supports Multiple Carriers – Flexible data plan options include Winegard no-contract 30-day plans, Verizon, and AT&T





AUTO GENERATOR START (WITH 1000 WATT INVERTER)

- Automatic generator turn on to meet air conditioning demands
- Regularly monitors and displays battery levels and provides power to the inverter to charge batteries
- Unique "look-ahead" feature tops off battery prior to "quiet time"
- Easily program your own "quiet time" hours and battery charging preferences
- Automatically starts/stops generator on low/full batteries
- Displays generator hour meter, maintenance reminders and diagnostic text messages for easy troubleshooting
- Safety start inhibits automatic generator starting in unsafe conditions

KEY OPTIONAL “PREMIER” FEATURES



OUTDOOR CAMP KITCHEN (319MB)

- Cold Water Sink
- Countertop Extension
- Refrigerator

EQUALIZER
SYSTEMS
A DAYS COMPANY



EQUALIZER RV STABILIZER SYSTEM - OPTIONAL

(Mandatory on 298KB, 311FS)

- Simple, electric operation
- Jacks down drive off alarm.
- Single button retract feature.
- Manual adjustment feature that allows you to operate each jack individually.
- Four point jack system

KEY OPTIONAL “PREMIER” FEATURES



BIGFOOT AUTO LEVELING SYSTEM - OPTIONAL

- Simple, one touch operation for fully automatic leveling.
- A single Central Hydraulic Pump.
- All-Up safety feature signals if one or more of the cylinders are not fully retracted before you drive off.
- Manual adjustment feature that allows you to operate each cylinder individually.
- Four powder coated cylinders rated to lift 8,000 pounds per cylinder and come with a LIFETIME CYLINDER WARRANTY.

KEY OPTIONAL “PREMIER” FEATURES

LEPRECHAUN

“PREMIER” MODELS



FIREPLACE – OPTIONAL (319MB Only)

- Internal Thermostat
- 6 Flame Light Intensities
- Shutoff Timer Feature
- Fahrenheit and Celsius Settings
- Remote Control

DUAL RECLINERS

- Individual Foot Rest
- Center Console
- Cup Holders



SOLID SURFACE KITCHEN COUNTERTOP – OPTIONAL

- Durability – Hard and Impact Resistant
- Non-porous – Resists Stains and Food-borne Bacteria
- Restorable – Damage can Often be Sanded Out and Repaired
- Easy Care – Wiping Clean Is Quick and Simple, Requiring Just Soap and Water

KEY OPTIONAL “PREMIER” FEATURES

LEPRECHAUN

“PREMIER” MODELS

WASHER/DRYER COMBO – OPTIONAL (298KB, 311FS)

- Maximum Performance, Minimum Consumption
- Super Silent – special sound-absorbing materials, and a tri-phase motor
- Multi Control – electronic control settings for great results - whiter whites, brighter colors
- Easy to use – Large 11.5” wide door, clearly display LED status Indicators, automatic wash to dry feature
- Extra Capacity – Class-leading load size capabilities
- Built tough – Equipped with heavy-duty springs and shock absorbers, stainless steel drums and reinforced cases for a long life



SPLENDIDE WDC7100XC - SPECIFICATIONS

- Electrical: 120V / 60Hz/11amp
- Weight: 148 lbs.
- Max. spin: 1200 rpm
- Cycles: 10 wash / 3 (+2 auto) dry
- Max. wash capacity: 15 lbs., Max. dry capacity: 11 lbs.
- Automatic water level control
- Add-an-Item feature
- Load balancing
- Self-cleaning pump
- Adjustable water temperature
- Silk and Wool cycles, Pre Wash, Extra rinse, Low spin, Low heat
- Wash water use: 7.5 to 16 gal/cycle
- Drying water use: 2.5 gal/hr.



SAFERIDE RV DIFFERENCE

- 12 million annual dispatches
- Largest contracted network
- Best on-time performance
- 6 redundant call centers
- 3,000 customer service agents
- Lowest claims severity in the marketplace
- 18 insurance companies
- Covering 27 auto manufacturing brands
- Competitive and affordable renewal pricing

<https://coachmenrv.com/owners#roadside>



UNLIMITED ROADSIDE ASSISTANCE BENEFITS

POWERED BY SAFERIDE MOTOR CLUB

- Towing
- Winching
- Jump Starts
- Fluid Delivery
- Tire Changes
- Mobile Mechanic
- Lockout Assistance
- Technical Assistance
- Dealer Locator Service

VALID FOR 1 YEAR FROM DATE OF PURCHASE



FOR CUSTOMER SERVICE,
CALL 888-890-1745

WEBSITE HELPFUL TOOLS

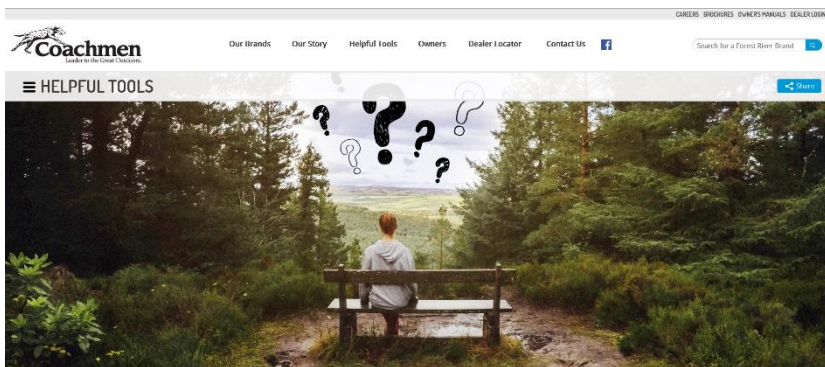

OUR HELPFUL TOOLS ASSIST YOU BEFORE, DURING, AND AFTER YOUR PURCHASE

- Answers to our most frequently asked questions
- Our RV Classifications, Commonly Used Terms And Weight Definitions
- RV Finder
- Towing Guidelines
- How-To Videos on most RV Systems and Maintenance Functions
- Payment Calculator

<https://coachmenrv.com/helpful-tools>

DIGITAL OWNER'S MANUAL

3 WAYS TO ACCESS YOUR OWNER'S MANUAL

- FREE MOBILE APP ON YOUR PHONE OR TABLET
- WEBSITE BASED MANUAL THROUGH YOUR BROWSER
- PDF DOWNLOAD FROM OUR WEBSITE

<https://coachmenrv.com/owners#manuals>



COACHMEN OWNER'S MANUAL "DIGITAL" APP

Now you can carry your owner's manual with you on your favorite device!

Download our FREE app from the Apple Store or Android Market Place and You'll have the information you need right at your fingertips.

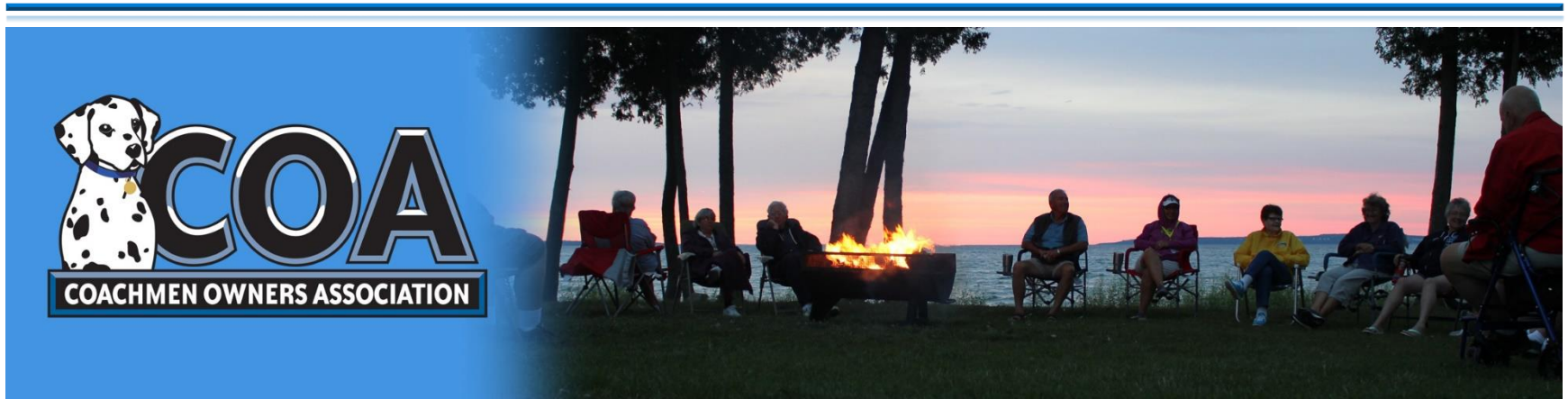

***COACHMEN IS PROUD TO SPONSOR ONE OF THE LARGEST MANUFACTURER SPONSORED
CAMPING CLUBS IN NORTH AMERICA***

Coachmen Owner's Association (COA) provides a broad breadth of value propositions for our owners including:

- Planned trips/tours and rallies at bulk rate discounts
- Free trip routing
- Free campground directory
- Free monthly email newsletters
- Mail forwarding
- Dedicated website
- Local and State club activities and Caravan Chapter membership opportunities
- Most importantly, COA enhances the Coachmen ownership and RV lifestyle experience. Every Coachmen RV owner is eligible for a FREE membership in the Coachmen Owner's Association.

Visit www.coachmenowners.com to learn more or to join the Coachmen Owner's Association.